



INSTALLATION INSTRUCTIONS

Accessory
SKID PLATE
P/N 0SP19-KRH-A00

Application
XR150L

Publication No.
MII 17935
Issue Date
April 2023

Honda Dealer: Please give a copy of these instructions to your customer.

PARTS LIST

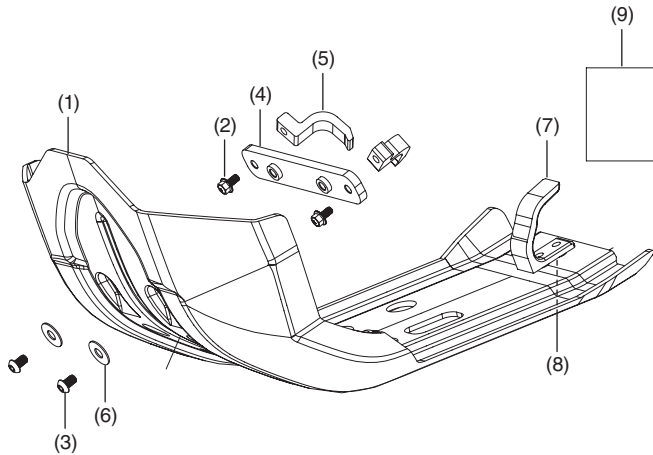

No.	Description	Qty.
(1)	Skid plate	1
(2)	6 × 16 mm Flange bolt	2
(3)	6 × 10 mm Socket bolt	4
(4)	Front bracket	1
(5)	Front hook	2
(6)	Washer	2
(7)	Rear hook (pre-installed)	1
(8)	Double washer (pre-installed)	1
(9)	Installation Instructions URL	1

TOOLS AND SUPPLIES REQUIRED

Socket (8 mm)
Ratchet
Hex wrench (4 mm)
Torque wrench

TORQUE CHART

Tighten all screws, bolts, and nuts to their specified torque values.

Item	N-m	kgf-m	lbf-ft
6 × 16 mm flange bolt	12	1.2	8.9
6 × 10 mm socket bolt	10	1.0	7.4

INSTALLATION

NOTE: Allow the vehicle to fully cool before installing this accessory.

1. Mount front bracket with front hooks to front down tube cradle of frame. Note installation direction of front bracket shown by "TOP" mark on the part. Bolt together with 6 × 16 mm flange bolts. Tighten to 12 N·m.

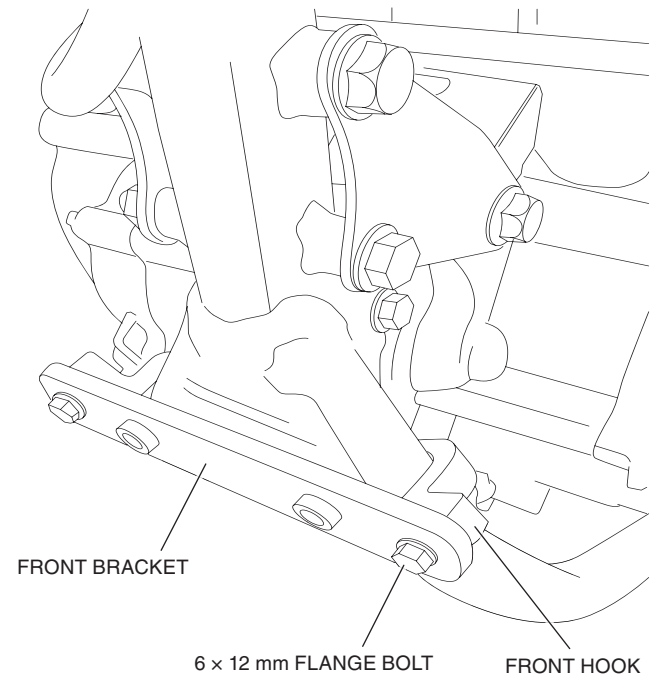
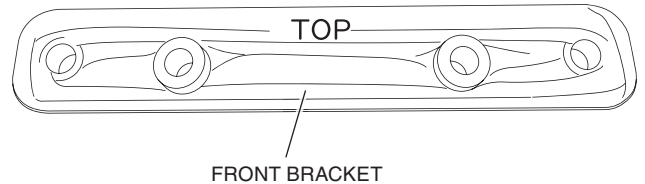

2. Guide rear hook on skid plate to lower cross tube at the back of frame.

NOTICE: Rear hook will fit between engine and cross tube in the middle.

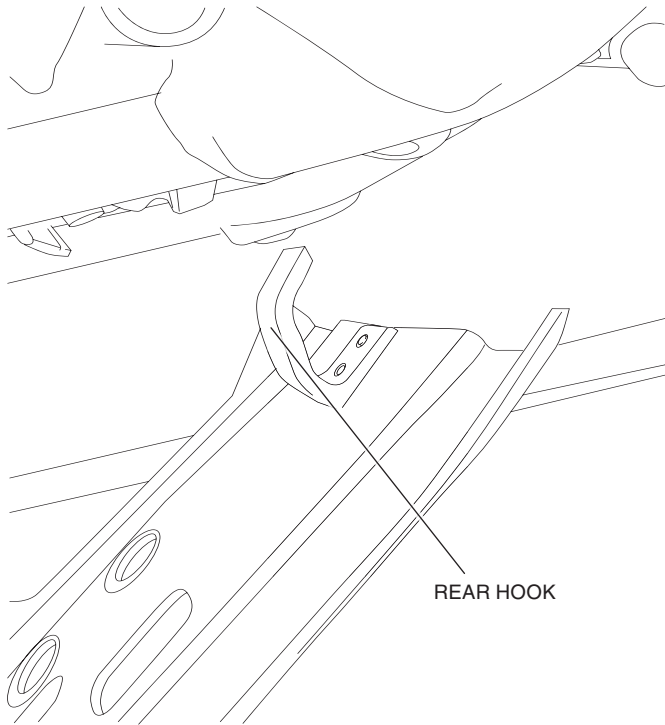

3. Raise skid plate to the front bracket (already mounted to frame).

NOTICE: Skid plate will pivot on rear hook to swing upward to the front bracket.

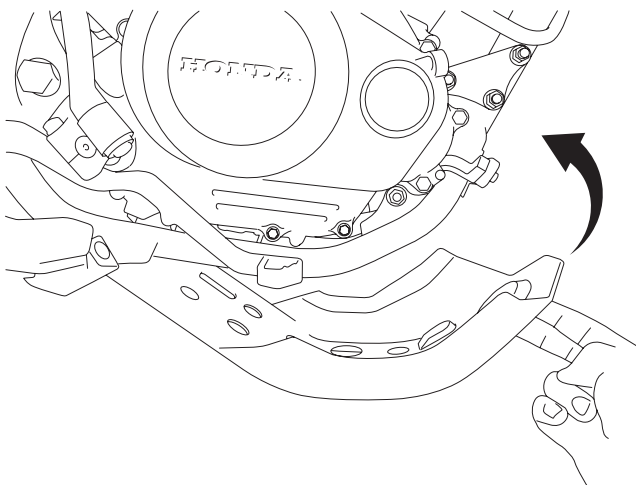

4. Attach 6 × 10 mm socket bolts with washers to the front bracket (already attached). Tighten to 10 N·m.

NOTICE: Skid plate should be close to the bottom of the frame before tightening.

